

FED. ROAD DIST. NO.	STATE	PROJECT NO.	FISCAL YEAR	SHEET NO.	TOTAL SHEETS
6	ARK.	A.P.F. 66A	1957	3	10
STATE JOB NO. 5207					

ALTERNATE "A"

RIGHT OF WAY DATA
Sta. 665+00 to Sta. 680+00 - 300' on left
Sta. 665+00 to Sta. 680+00 - 100' on right

TANGENT DISTANCE DATA
From Beginning of Bridge - 72.7'
From End of Bridge - over 500'

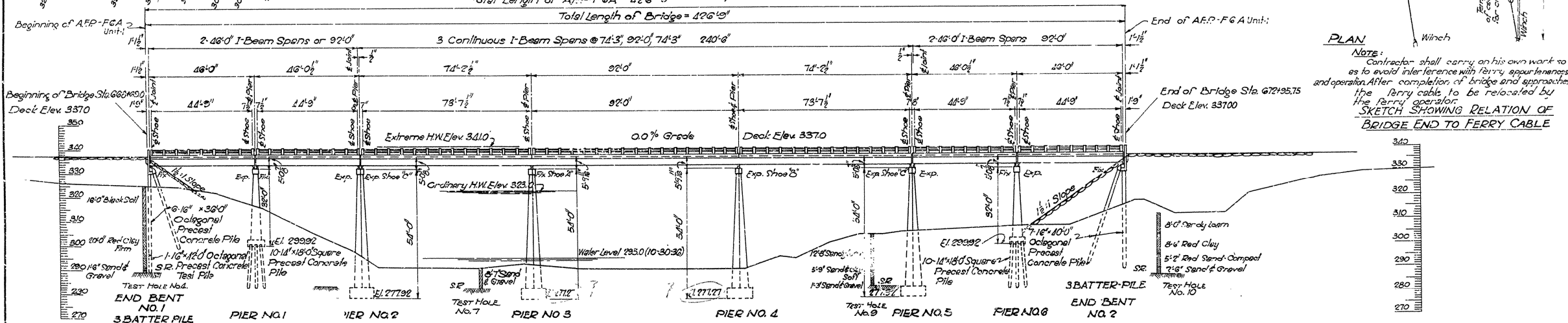
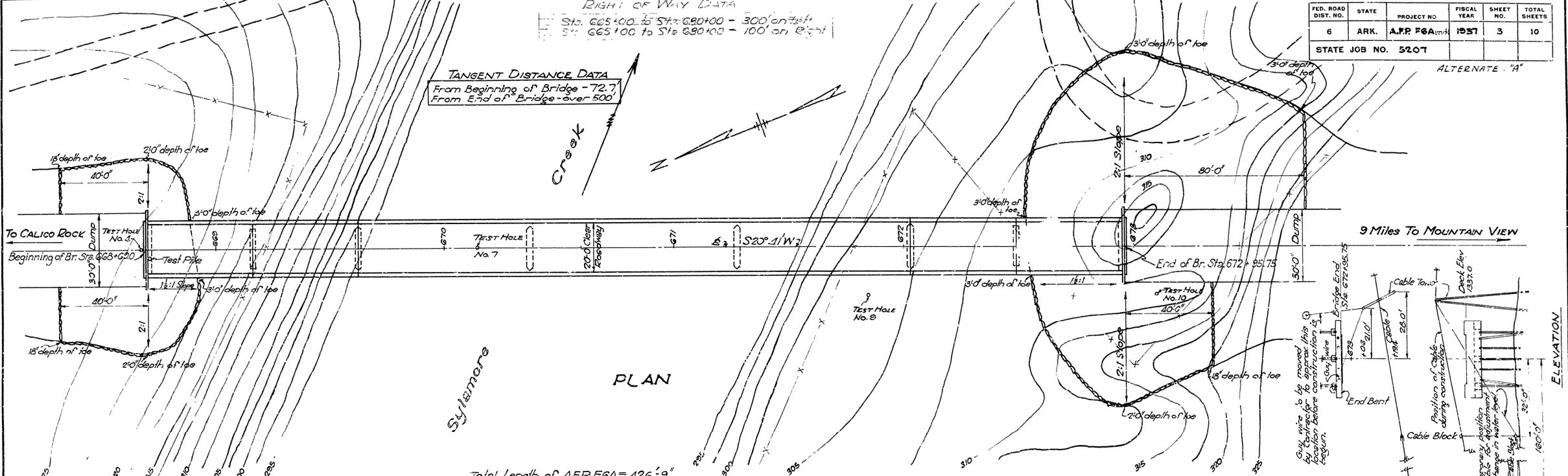

PLAN
Note:
Contractor shall carry on his own work so as to avoid interference with ferry, apparatus and operation. After completion of bridge and approach the ferry cable to be relocated by the ferry operator.
SKETCH SHOWING RELATION OF BRIDGE END TO FERRY CABLE

GENERAL NOTES:
Expansion joints to be constructed as shown on "Layout".
All concrete to be poured in the dry. All exposed corners shall have 1" chamfer unless otherwise noted.
In general all construction joints in Piers and End Bents shall be horizontal and shall be provided with keys not less than 3" deep, covering the middle third of both dimensions.
Reinforcing steel shall be deformed bars of structural or intermediate grade. Shop list and bending diagrams must be submitted and approved before fabrication is begun.
Lengths of piling shown are for estimating purposes only. Actual lengths of piling are to be determined in the field.
Precast concrete pile to be Class "S" Concrete, and shall be driven to solid rock, or to have a minimum capacity of 30 tons each and also a penetration of not less than 20 feet, whichever is reached first.

ELEVATION
Volume occupied by embedded pile heads will not be included in the pay quantities of concrete caps.
Embankment and Rip Rap at Bridge ends to be placed under another contract.
Payment for any work necessary to protect or adjust ferry apparatuses during construction to be included in the unit price bid for "Dry Excavation for Structures".
For Details of End Bents Nos. 1 & 2, and Piers Nos. 1 & 2, see Drwg. No. 4737
For Details of Piers Nos. 3, 4 & 5, see Drwg. No. 4738
For Details of 74'-3" 92'-0" 74'-3" Continuous I-Beam Spans, see Drwg. No. 5211 & 5212
For Details of 48'-0" I-Beam Spans, see Drwg. No. 5201
Specifications: Arkansas State Highway Commission Standard Specifications for Road and Bridge Construction, adopted June 30, 1936

B.M. Elev. 310.20 Nail in roof of 10' Persimmon Sump 100' E. Sta. 669+100
B.M. Elev. 308.30 Nail in knot of 8" Hackberry 30' E. Sta. 672+50
Drainage Area = 220 Sq. Miles - Mountainous
Revised: Dimension from crown to top of cap - Piers 3 & 4 - N.C.H. 12-17-38
Revised: Added sketch showing location ferry cable - N.B. 2-17-38
N.B. SHAW
BRIDGE ENGINEER

LAYOUT OF
BRIDGE OVER SYLAMORE CREEK
MOUNTAIN VIEW - CALICO ROCK ROAD
STONE COUNTY
ROUTE SEC.
ARKANSAS STATE HIGHWAY COMMISSION
LITTLE ROCK, ARK.
Drawn By: A.W.D. Date: 6-5-37
Traced By: A.W.D. Date: 2-7-37
Checked By: _____ Date: _____
BRIDGE NO. 1399 DRAWING NO. 4736
Scale: 1 in. = 20 ft.

